

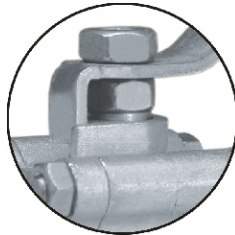

3 Piece Flange End Full Bore Ball Valve

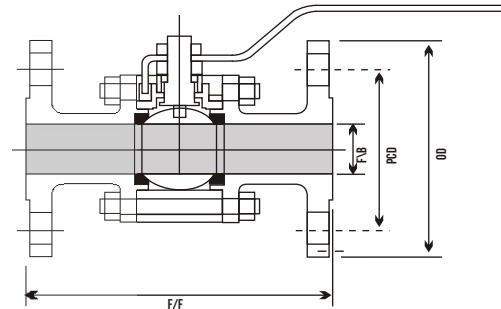

SQUARE BODY TYPE DESIGN

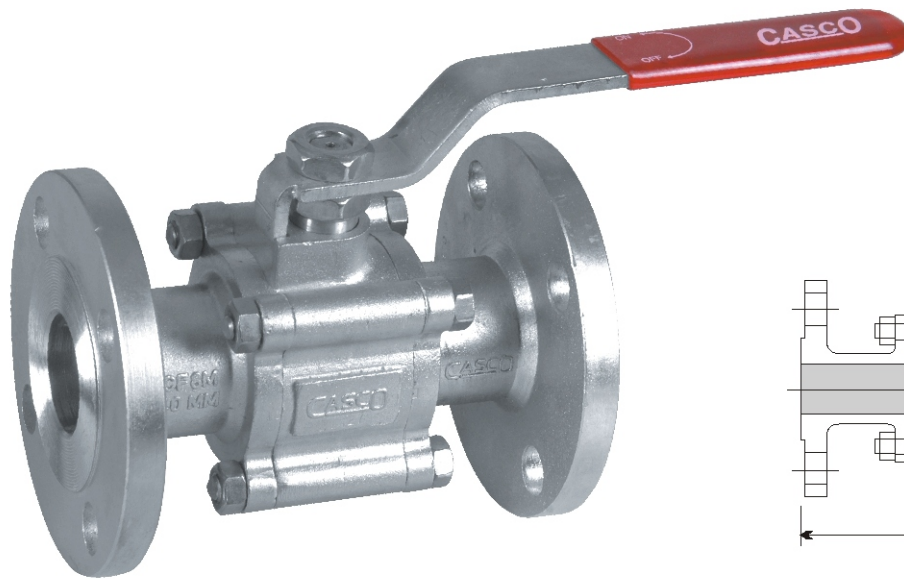
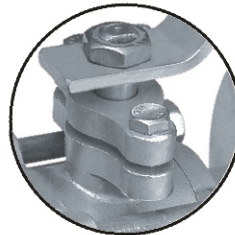

GLAND TYPE DESIGN

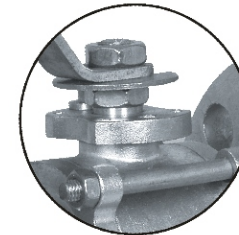

ACTUATOR MOUNTED PAD TYPE DESIGN

Features		Material Specifications		
DESIGN STD	AS PER BS 5351	1	BODY	CF8M, CF8, CF3M, CF3, WCB ETC.
FACE TO FACE	AS PER ASME B 16.10	2	SIDE PIECE	CF8M, CF8, CF3M, CF3, WCB ETC.
FLANGE END	AS PER ANSI B 16.5	3	BALL	SS 316., SS 304, SS 316L, 304L ETC.
TESTING STD	AS PER BS 5146, ISO 5208	4	SEAT	PTFE, GLASS OR CARBON PTFE ETC.

Salient Features

- (1) SQUARE BODY, GLAND TYPE BODY AND ACTUATOR MOUNTED PAD TYPE BODY AVAILABLE
- (2) INVESTMENT CASTINGS BODY, SIDE PIECE
- (3) PNEUMATIC ACTUATOR OPERATED BALL VALVE AVAILABLE ON REQUEST.

Hydro Test Pressure

	SHELL	SEAT
150 #, "E", "F"	32 KG/CM ²	23 KG/CM ²
300 #	79 KG/CM ²	58 KG/CM ²

Details of Dimension

Class	150 #			300 #			"E" Table			"F" Table		
	F/F	PCD	OD	F/F	PCD	OD	F/F	PCD	OD	F/F	PCD	OD
15	108	60.5	89	140	67	95	108	66.6	95	108	66.6	95
20	117	70	98.5	152	83	117	117	73	101.5	117	73	101.5
25	127	79.5	108	165	89	124	127	82.5	114.5	127	87.8	120.5
40	165	98.5	127	191	114	156	165	98.5	133.5	165	104.7	140
50	178	120.5	152.5	216	127	165	178	114.3	152.5	178	127	165
65	190	140	178	241	149	190	190	127	165	190	146	184
80	203	152.5	191	283	168	210	203	146	184	203	165	203
100	229	190.5	229	305	200	254	229	177.8	216	229	190.5	229
150	267	241.5	279.5	403.5	270	317						
200	292	298.5	343	419.5	330	381						
250	330	362	406.5	457	387	444						
300	356	432	482.5	502	451	521						