

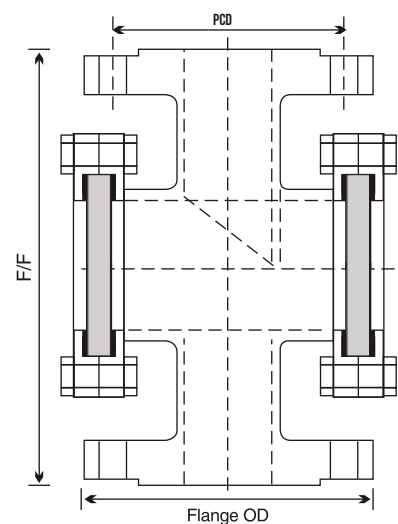

# Double Window Sight Glass / Sight Flow Indicator

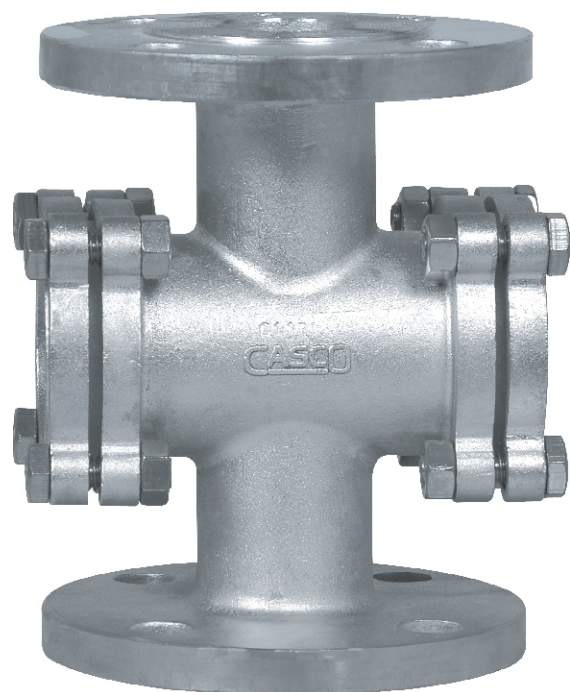

Features		Material Specifications		
DESIGN STD	AS PER BS 535 1	1	BODY	CF8M, CF8, CF3M, CF3, WCB ETC.
FACE TO FACE	AS PER ASME B 16. 10	2	SIDE PIECE	CF8M, CF8, CF3M, CF3, WCB ETC.
FLANGE END	AS PER ASME B 16. 5	3	GLASS	TOUGHENED GLASS
TESTING STD	AS PER BS 5 146, ISO 5208	4	GASKET	PTFE, GLASS OR CARBON PTFE ETC.

Details of Dimension						
Class	150 #					
Size	F/F	Flange OD	PCD	Dia RF	Hole Dia	No of Hole
15	108	89	60.5	35	16	4
20	117	98.5	70	43	16	4
25	127	108	79.5	51	16	4
40	165	127	98.5	73	16	4
50	178	152.5	120.5	92	19	4
65	190	178	140	105	19	4
80	203	191	152.5	127	19	4
100	229	229	190.5	157	19	8
150	267	279.5	241.5	216	22.50	8
200	292	343	298.5	270	22.50	8

## Salient Features

- (1) SINGLE PIECE DESIGN INVESTMENT CASTING BODY & SIDE PLATE.
- (2) 300 # AVAILABLE ON BULK REQUIREMENT.
- (3) SCREWED END DOUBLE WINDOW AVAILABLE ON BULK REQUIREMENT.

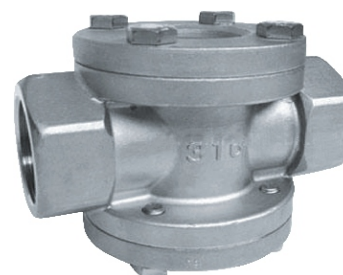

Screwed End Double Window